





**Timmins Martelle
Heritage Consultants Inc.**

Cemetery and Burial Investigation Services



©2018 Timmins Martelle Heritage Consultants Inc.

@ Museum of Ontario Archaeology

1600 Attawandaron Road

London, Ontario

N6G 3M6

Phone: (519) 641-7222

E-mail: ktheaker@tmhc.ca

All images feature TMHC fieldwork and associated locales. Further contextual information is not provided respecting the sensitive nature of these areas.

A photograph of a cemetery on a foggy day. Large, dark evergreen trees stand behind a black metal fence. The ground is covered in dry, yellowish grass. In the background, several tombstones are visible through the mist.

Who we are...

Timmins Martelle Heritage Consultants Inc. (TMHC) embraces respectful and innovative conservation of Ontario's cultural heritage. As heritage resources, cemeteries reflect our shared history. As the sacred resting place of loved ones, they deserve our greatest respect.

Our cemetery and burial investigation team work in partnership with municipalities, Indigenous and other Descendant communities, public and private organizations, scholars and the general public to manage a variety of cemetery types, from ancestral graves, small family plots and church yard burial grounds to large municipal cemeteries.

Although caring for grave sites is our shared responsibility, the Funeral, Burial and Cremation Services Act (FBCSA) ensures cemeteries are properly identified, managed and protected. The Bereavement Authority of Ontario (BAO) and Ministry of Government and Consumer Services (MGCS) ensure compliance with the FBCSA and offer guidance on how to address accidental discoveries of ancestral remains and manage the precise locating of interments in aging cemeteries where burials may no longer be marked by stones. The original boundaries of older cemeteries are often not clearly demarcated, especially when encroached by development and agricultural ploughing or when former fences have fallen down or been dismantled.





TMHC's Cemetery and Burial Investigations preserve, protect and restore final resting places.

Did you know...

- Burial site investigations are required by the Funeral, Burial and Cremation Services Act (FBCSA)?
- The FBCSA requires a professionally licensed archaeologist to a complete burial site investigation?

TMHC's experts have helped a variety of clients, from individual homeowners to municipalities, churches to the provincial government, successfully meet FBCSA requirements for burial site investigations using a combination of traditional archaeological methods and leading edge technologies.



Human remains have been found on your property...

FBCSA Burial site investigations, what you need to know

Let us help

- Guide you through the process from discovery to re-interment.
- Liaison with the Registrar of Burial Sites to confirm requirements are being met at each stage of the FBCSA process.
- Provide dedicated, experienced experts to complete required investigations quickly and in compliance with government requirements.
- Provide expert advice to complete the site disposition agreement.

Did you know...

- Provincial legislation may trigger the need for an archaeological assessment if:
 - a) a development property sits adjacent to a known cemetery;
 - b) other documentation suggests there is potential for the presence of a cemetery or burial site?
- Accidental discovery after development has begun can cause significant delays?



TMHC is a respected leader in cultural resource management and helps a wide range of clients complete due diligence assessments prior to development, reducing risks of delays.

Don't know if you have a cemetery or a burial site?

Let us help

- Provide experienced staff to complete detailed historical research.
- Complete archaeological fieldwork to confirm whether a cemetery or burial site is present.
- Provide expert advice on what to do next should a cemetery or burial site be confirmed.

Did you know...

Under the FBCSA it is a finable offence to:

- Disinter human remains without consent from the Registrar?
- Build a structure within 4.57 m (15 feet) of a burial?
- Inter human remains within 4.57 m (15 feet) of a structure?

TMHC's reputation for excellence has helped numerous clients comply with provincial requirements by working collaboratively with Indigenous and Descendent communities, the Bereavement Authority of Ontario and Ministry of Government and Consumer Services.

Planning an alteration within or adjacent to a registered cemetery?

Let us help

- Provide expert advice on what will be required.
- Provide mapping and inventories of existing graves within your cemetery.
- Complete any required archaeological assessment to confirm there are no burials outside of the marked cemetery boundary.
- Liaison with Ministry of Tourism, Culture and Sport and the Bereavement Authority of Ontario to ensure compliance.

Archaeological Assessments

Cemetery investigations are undertaken by professional, licensed archaeologists. The methods used for locating, defining, and protecting cemeteries and burial sites are government-enforced requirements that involve successive stages of background research, site survey, ground testing and excavation or protection.



Services: Archaeological Assessments





Services: Ground Penetrating Radar

Ground Penetrating Radar

Partnering with Sustainable Archaeology and Western University, TMHC offers state-of-the-art ground penetrating radar (GPR) services. Useful for detecting subsurface ground disturbances, including grave shafts, GPR is a popular, non-intrusive way of beginning most cemetery investigations.

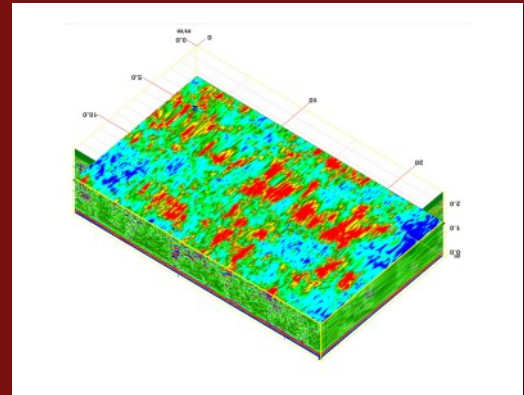

Detailed Historical Research

Detailed historical research is often a low cost, quick starting point for any cemetery investigation. Historic records can be a valuable source of information about a cemetery providing insights into its original deeded boundaries, the people who have been buried there, period of use and formal closing.

RECORD OF										DEATHS									
DATE	NAME	AGE	SEX	RES.	DATE	NAME	AGE	SEX	RES.	DATE	NAME	AGE	SEX	RES.	DATE	NAME	AGE	SEX	RES.
1871	James D. Moore	24	M	Wm.	1871	James D. Moore	24	M	Wm.	1871	James D. Moore	24	M	Wm.	1871	James D. Moore	24	M	Wm.
1872	John D. Moore	25	M	Wm.	1872	John D. Moore	25	M	Wm.	1872	John D. Moore	25	M	Wm.	1872	John D. Moore	25	M	Wm.
1873	John D. Moore	26	M	Wm.	1873	John D. Moore	26	M	Wm.	1873	John D. Moore	26	M	Wm.	1873	John D. Moore	26	M	Wm.
1874	John D. Moore	27	M	Wm.	1874	John D. Moore	27	M	Wm.	1874	John D. Moore	27	M	Wm.	1874	John D. Moore	27	M	Wm.
1875	John D. Moore	28	M	Wm.	1875	John D. Moore	28	M	Wm.	1875	John D. Moore	28	M	Wm.	1875	John D. Moore	28	M	Wm.
1876	John D. Moore	29	M	Wm.	1876	John D. Moore	29	M	Wm.	1876	John D. Moore	29	M	Wm.	1876	John D. Moore	29	M	Wm.
1877	John D. Moore	30	M	Wm.	1877	John D. Moore	30	M	Wm.	1877	John D. Moore	30	M	Wm.	1877	John D. Moore	30	M	Wm.
1878	John D. Moore	31	M	Wm.	1878	John D. Moore	31	M	Wm.	1878	John D. Moore	31	M	Wm.	1878	John D. Moore	31	M	Wm.
1879	John D. Moore	32	M	Wm.	1879	John D. Moore	32	M	Wm.	1879	John D. Moore	32	M	Wm.	1879	John D. Moore	32	M	Wm.
1880	John D. Moore	33	M	Wm.	1880	John D. Moore	33	M	Wm.	1880	John D. Moore	33	M	Wm.	1880	John D. Moore	33	M	Wm.
1881	John D. Moore	34	M	Wm.	1881	John D. Moore	34	M	Wm.	1881	John D. Moore	34	M	Wm.	1881	John D. Moore	34	M	Wm.
1882	John D. Moore	35	M	Wm.	1882	John D. Moore	35	M	Wm.	1882	John D. Moore	35	M	Wm.	1882	John D. Moore	35	M	Wm.
1883	John D. Moore	36	M	Wm.	1883	John D. Moore	36	M	Wm.	1883	John D. Moore	36	M	Wm.	1883	John D. Moore	36	M	Wm.
1884	John D. Moore	37	M	Wm.	1884	John D. Moore	37	M	Wm.	1884	John D. Moore	37	M	Wm.	1884	John D. Moore	37	M	Wm.
1885	John D. Moore	38	M	Wm.	1885	John D. Moore	38	M	Wm.	1885	John D. Moore	38	M	Wm.	1885	John D. Moore	38	M	Wm.
1886	John D. Moore	39	M	Wm.	1886	John D. Moore	39	M	Wm.	1886	John D. Moore	39	M	Wm.	1886	John D. Moore	39	M	Wm.
1887	John D. Moore	40	M	Wm.	1887	John D. Moore	40	M	Wm.	1887	John D. Moore	40	M	Wm.	1887	John D. Moore	40	M	Wm.
1888	John D. Moore	41	M	Wm.	1888	John D. Moore	41	M	Wm.	1888	John D. Moore	41	M	Wm.	1888	John D. Moore	41	M	Wm.
1889	John D. Moore	42	M	Wm.	1889	John D. Moore	42	M	Wm.	1889	John D. Moore	42	M	Wm.	1889	John D. Moore	42	M	Wm.
1890	John D. Moore	43	M	Wm.	1890	John D. Moore	43	M	Wm.	1890	John D. Moore	43	M	Wm.	1890	John D. Moore	43	M	Wm.
1891	John D. Moore	44	M	Wm.	1891	John D. Moore	44	M	Wm.	1891	John D. Moore	44	M	Wm.	1891	John D. Moore	44	M	Wm.
1892	John D. Moore	45	M	Wm.	1892	John D. Moore	45	M	Wm.	1892	John D. Moore	45	M	Wm.	1892	John D. Moore	45	M	Wm.
1893	John D. Moore	46	M	Wm.	1893	John D. Moore	46	M	Wm.	1893	John D. Moore	46	M	Wm.	1893	John D. Moore	46	M	Wm.
1894	John D. Moore	47	M	Wm.	1894	John D. Moore	47	M	Wm.	1894	John D. Moore	47	M	Wm.	1894	John D. Moore	47	M	Wm.
1895	John D. Moore	48	M	Wm.	1895	John D. Moore	48	M	Wm.	1895	John D. Moore	48	M	Wm.	1895	John D. Moore	48	M	Wm.
1896	John D. Moore	49	M	Wm.	1896	John D. Moore	49	M	Wm.	1896	John D. Moore	49	M	Wm.	1896	John D. Moore	49	M	Wm.
1897	John D. Moore	50	M	Wm.	1897	John D. Moore	50	M	Wm.	1897	John D. Moore	50	M	Wm.	1897	John D. Moore	50	M	Wm.
1898	John D. Moore	51	M	Wm.	1898	John D. Moore	51	M	Wm.	1898	John D. Moore	51	M	Wm.	1898	John D. Moore	51	M	Wm.
1899	John D. Moore	52	M	Wm.	1899	John D. Moore	52	M	Wm.	1899	John D. Moore	52	M	Wm.	1899	John D. Moore	52	M	Wm.
1900	John D. Moore	53	M	Wm.	1900	John D. Moore	53	M	Wm.	1900	John D. Moore	53	M	Wm.	1900	John D. Moore	53	M	Wm.

Services: Detailed Historical Research

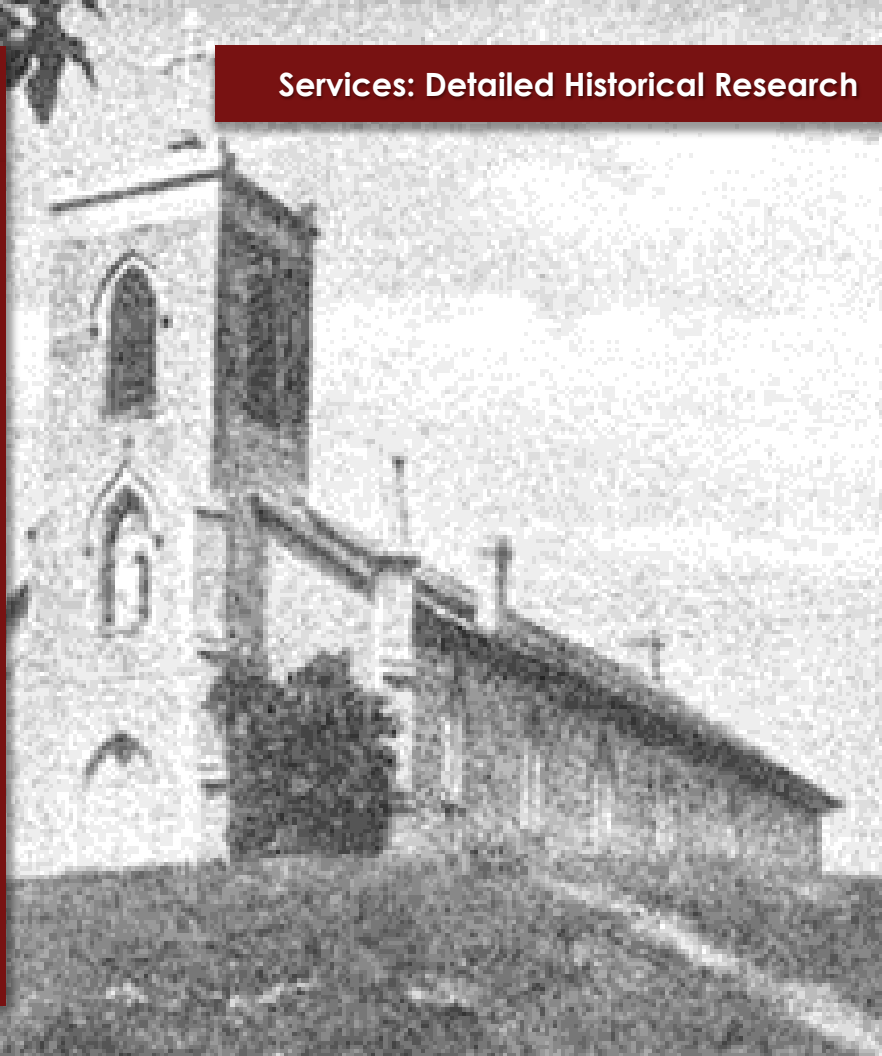

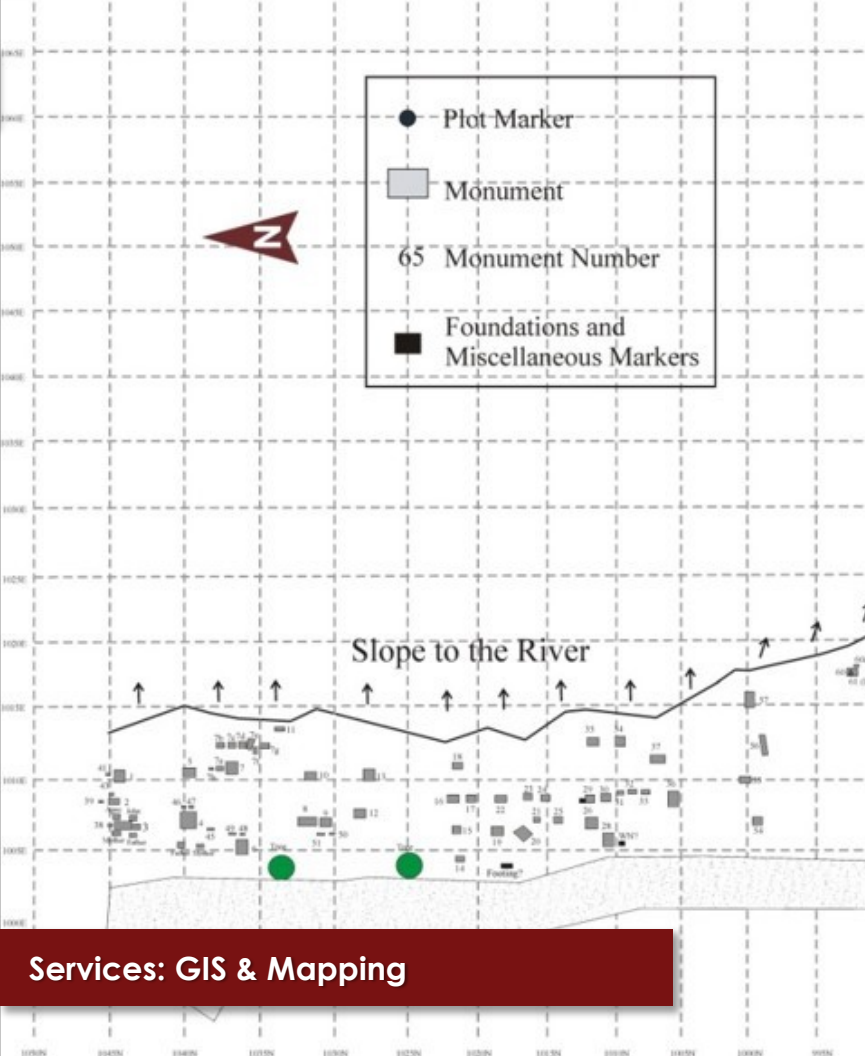

Services: GIS & Mapping

GIS & Mapping

Whether mapping the features within a cemetery or its relationship to the surrounding landscape, Geographic Information Systems (GIS) is an effective tool to manage spatial information. TMHC offers a wide range of mapping options that can be tailored to suit your needs.

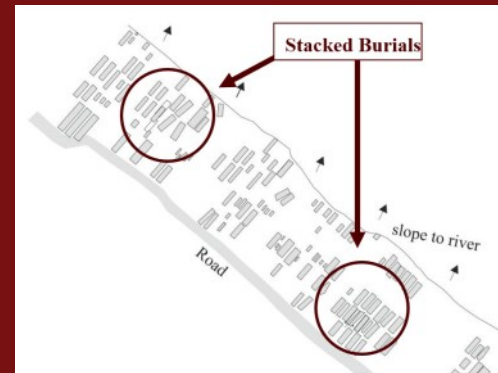



©2018 Timmins Martelle Heritage Consultants Inc.
@ Museum of Ontario Archaeology
1600 Attawandaron Road
London, Ontario
N6G 3M6

Phone: (519) 641-7222

E-mail: ktheaker@tmhc.ca